

**Restauration complète de l'ancienne Banque de France**

44-46 rue de Bretagne - 53000 LAVAL

**Dossier de déclaration d'Utilité Publique**



ARCHITECTES



**Agence Lionel ViÉ & Associés**

23 rue Guillier de la Touche  
49100 ANGERS  
Tél. 02.41.21.15.52  
Tél. 02.41.21.15.51  
E-mail : info@lionel-vie.fr  
Site : www.lionel-vie.fr

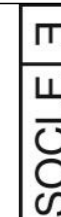

**SOCLE - architecture**

Agence de Nantes  
7 rue Condorcet - 44000 NANTES  
Tél: 02.40.73.77.20  
E-mail: contact@gdvarchitecture.com  
Site: www.socle-architecture.com

**DUP - PLAN DE MASSE**

- 3.1 Plan de masse - Etat actuel
- 3.2 Plan de masse - Etat projeté

Indice:	Date:	Modifications:		
<b>DOSSIER 1831</b>		<b>DATE:</b> 09.11.2021	<b>PHASE</b>	<b>PLAN N°</b>
<b>PLANS ARCHITECTE</b>		<b>ECHELLE</b>	<b>DUP</b>	<b>3</b>

**LEGENDE**

-  Limite de propriété
-  PARTIES déposées
-  PAVES
-  DALLAGE
-  Surfaces enherbées
-  HAIES DE TUYAS
-  ARBRES existants

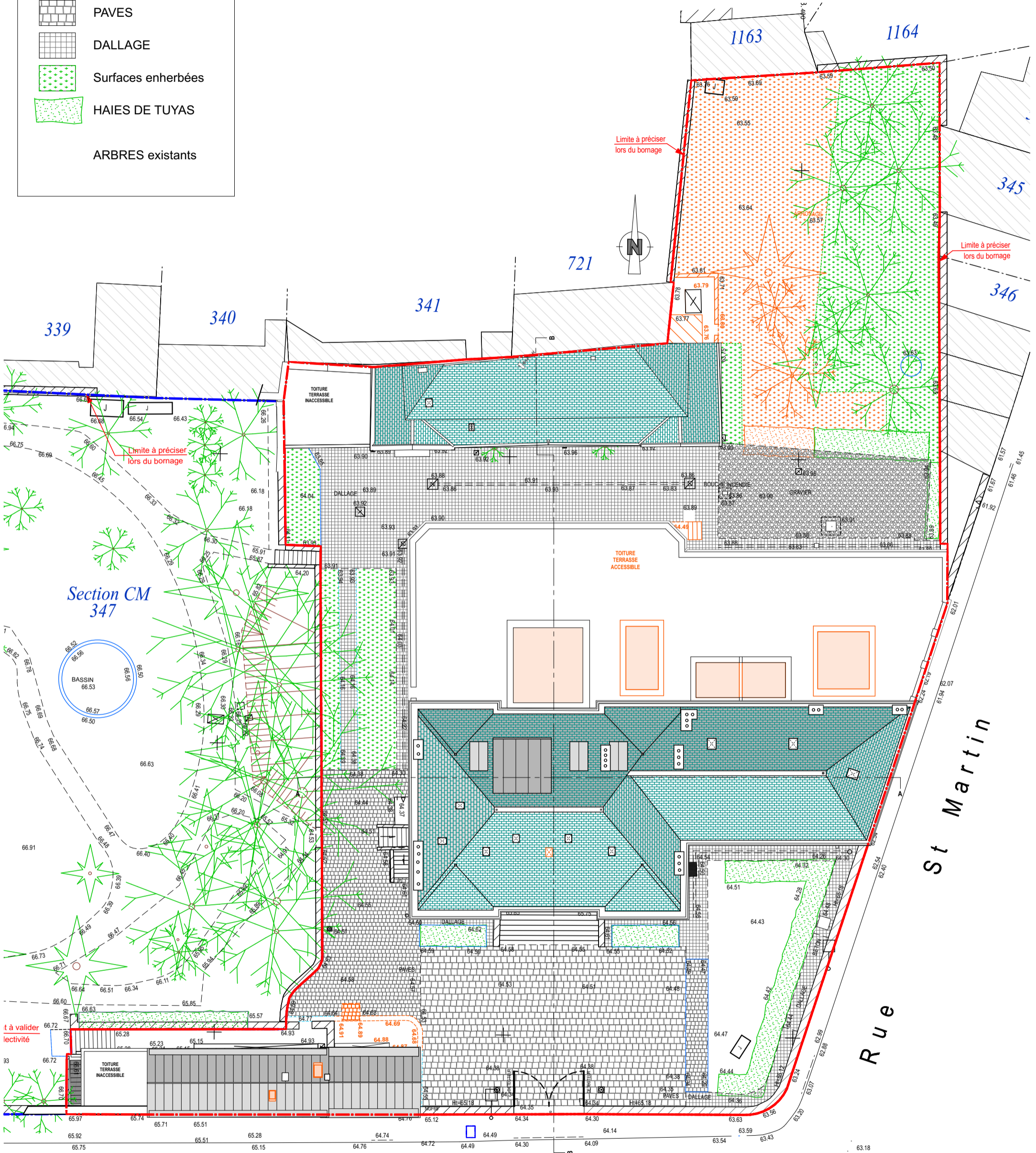

Rue de Bretagne

Maitre d'oeuvre : **SOCLE E**  
 Lionel Vie  
 ARCHITECTURE et ECONOMIE









Restauration complète de l'ancienne Banque de France  
 44-46 rue de Bretagne LAVAL

PLAN DE MASSE - ETAT ACTUEL

Echelle : 1:250	Phase :	Plan n° :
Date : 09.11.2021	<b>DUP</b>	<b>3.1</b>



**LEGENDE**

-  Limite de propriété
-  PAVES
-  DALLAGE
-  Surfaces enherbées
-  HAIES DE TUYAS
-  ARBRES existants
-  VOIE de desserte
-  PARKING enherbé
-  JARDINIÈRES

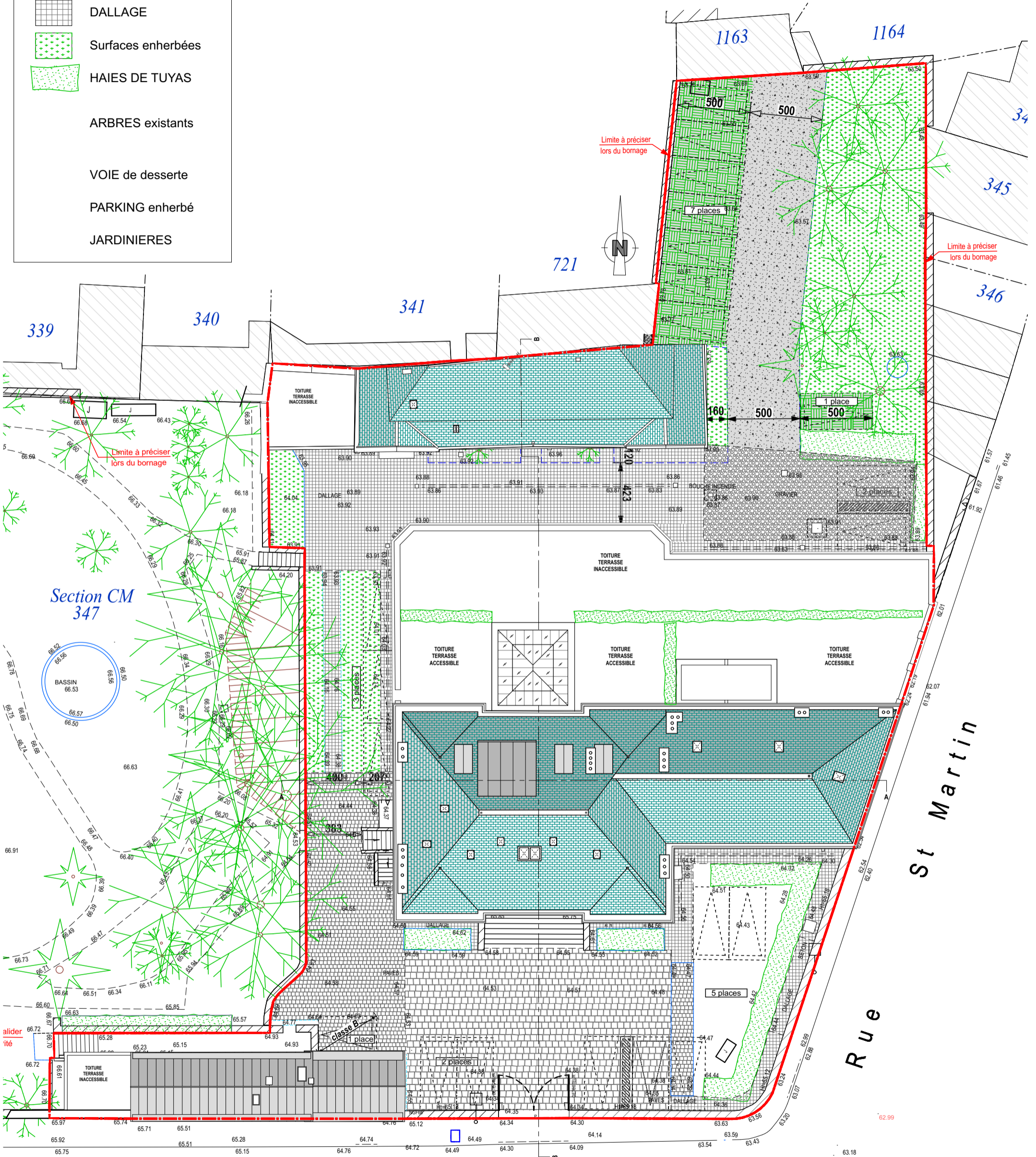

Rue de Bretagne

<p>Maitre d'oeuvre :</p>  <p><b>SOCLE</b></p> <p>ARCHITECTURE et ÉCONOMIE</p>	<p>Restauration complète de l'ancienne Banque de France 44-46 rue de Bretagne LAVAL</p> <p><b>PLAN DE MASSE - ETAT PROJETE</b></p>	<p>Echelle : 1:250</p> <p>Date : 09.11.2021</p>	<p>Phase :</p> <p><b>DUP</b></p>	<p>Plan n°:</p> <p><b>3.2</b></p>
---	--	---	----------------------------------	-----------------------------------